



**Tamar Mepe Street and Kvaiti Ubani Connecting Road  
(Town of Martvili) Rehabilitation**

**Sub-Project Environmental and Social Screening and  
Environmental Management Plan**

**WORLD BANK FINANCED**

**SECOND REGIONAL AND MUNICIPAL INFRASTRUCTURE DEVELOPMENT PROJECT**

## Environmental Screening

Sub-project (SP) will rehabilitate Tamar Mepe Street and Kvaiti Ubani connecting road with total length of 3 360 m in the town of Martvili, Martvili Municipality, Samegrelo-Zemo Svaneti region.

The SP includes:

- Rehabilitation of the road cover with asphalt-concrete layer;
- Installation of the concrete ditches ( 1 219 m);
- Installation of pipes at the accession of the courtyards;
- Arrangement of the retaining wall along the road section pk 5+14 (12 m).

### (A) IMPACT IDENTIFICATION

<p>Has sub-project a tangible impact on the environment?</p>	<p>The SP has a modest short term negative environmental impact while its long term impact is expected to be positive.</p> <p>The main impact will be during the construction phase, which includes works for laying various layers, movement and operation of heavy vehicles, supply of materials. The roads to be rehabilitated are located within a settlement with strongly modified environment. Therefore the impact is transitory and insignificant (noise, emissions, construction waste, temporary disturbance of traffic and access, etc.).</p>
<p>What are the significant beneficial and adverse environmental effects of sub-project?</p>	<p>The SP will have a long term positive social impact through improving living and transportation conditions of the local population. It will decrease existing negative impacts on community such as dust, emissions and noise.</p> <p>The expected negative environmental and social impacts are likely to be short term and typical for small to medium scale rehabilitation works in urban landscape: noise, dust, vibration, and emissions from the operation of construction machinery; generation of construction waste; disruption of traffic and pedestrian access.</p> <p>To minimize road crossing ponding and flooding risk, works for cleaning of existing storm water ditches, as well as arrangement of the concrete and ground ditches along the road is planned within the SP.</p> <p>Asbestos contained waste will be generated due to the demolition of the existing asbestos pipes (52 m) at the accessions of the courtyards.</p> <p>Due to narrow road corridors (about 5 m) that lay between private properties (residential yards), arrangement of sidewalks is impossible without involuntary resettlement, which is justifiable</p>

	<p>neither from financial, nor from social standpoint. Speed bumps and limiting signs will be arranged to increase pedestrian safety.</p> <p>Trimming canopies of trees and cut of shrubs along the some sections of the road will be needed for improving visibility.</p>
<p>May the sub-project have any significant impact on the local communities and other affected people?</p>	<p>No land take and relocation are expected.</p> <p>Existing wire fence (12 m) along the private courtyard will be dismantling and new one will be installed due to the arrangement of the retaining wall along the road section pk 5+14. Replacement of the existing fence with new one is agreed with owner in written.</p> <p>The long term social impact will be beneficial (improvement of local population's living conditions, better traffic safety conditions, convenience of travelling).</p> <p>Negative impacts are short term and limited to the construction site. They are related to the possible disturbance described above.</p>

**(B) MITIGATION MEASURES**

<p>Were there any alternatives to the sub-project design considered?</p>	<p>Given that the SP envisages rehabilitation of the existing infrastructure, no alternatives have been considered.</p>
<p>What types of mitigation measures are proposed?</p>	<p>The expected negative impacts of the construction phase can be easily mitigated. The contractor will be responsible for the waste disposal at the permitted location, use the quarry materials from the licensed quarries only, prevent water and soil from pollution (fuel spills due to equipment failure, raw asphalt/concrete spills etc.), avoid disturbance of population (noise, dust, emissions) through proper work/supplies scheduling, traffic management, good maintenance of the construction machinery, etc.</p> <p>Asbestos pipes will be demolished and disposed following to the procedures described in the EMP and in accordance with written agreement with landfill operating organization. Demolition works and proper disposal of the asbestos pipes will be strictly controlled by MDF.</p>
<p>What lessons from the previous similar projects have been incorporated into the sub-project design?</p>	<p>MDF have wide experience of implementation of medium and large scale road and streets rehabilitation subprojects financed by various donor organizations. Based on lessons learned from previous similar projects, design envisages not only rehabilitation</p>

	<p>of road pavement but also rehabilitation of storm water ditches which will backing further maintenance of the street cover.</p>
<p>Have concerned communities been involved and have their interests and knowledge been adequately taken into consideration in sub-project preparation?</p>	<p>The SP has been developed by the Municipality in consultation with the affected communities and as a response to the current situation.</p> <p>Local population have been informed about scheduled rehabilitation works and has no claim on related disturbances.</p> <p>Draft EMP was disclosed on the web-site of MDF. Hard copies of the document was made available at the MDF and Martvili municipality. Announcement on the public consultation meeting was placed on public information board in the administration building of Martvili Municipality.</p> <p>MDF and local municipality organized consultation meeting with local population on July 28, 2015.</p>

**(C) RANKING**

The project has been classified as environmental Category B according to the World Bank safeguards (OP 4.01) and requires Completion of the Environmental Management Checklist for Small Construction and Rehabilitation Activities.

## Social Screening

Social safeguards screening information		Yes	No
1	Is the information related to the affiliation, ownership and land use status of the sub-project site available and verifiable? (The screening cannot be completed until this is available)	✓	
2	Will the sub-project reduce people's access to their economic resources, such as land, pasture, water, public services, sites of common public use or other resources that they depend on?		✓
3	Will the sub-project result in resettlement of individuals or families or require the acquisition of land (public or private, temporarily or permanently) for its development?		✓
4	Will the sub-project result in the temporary or permanent loss of crops, fruit trees and Household infra-structure (such as ancillary facilities, fence, canal, granaries, outside toilets and kitchens, etc.)?	✓	
If answer to any above question (except question 1) is "Yes", then OP/BP 4.12 Involuntary Resettlement is applicable and mitigation measures should follow this OP/BP 4.12 and the <b>Resettlement Policy Framework</b>			

Existing wire fence (12 m) along the private courtyard will be dismantled and new one will be installed after arrangement of the retaining wall along the road section pk 5+14. Replacement of the existing fence with new one is agreed with the owner in written.

**PART A: GENERAL PROJECT AND SITE INFORMATION**

<b>INSTITUTIONAL &amp; ADMINISTRATIVE</b>			
Country	Georgia		
Project title	Regional and Municipal Infrastructure Development II		
Sub-Project title	Tamar Mepe Street and Kvaiti Ubani Connecting Road (Town of Martvili) Rehabilitation		
Scope of site-specific activity	<p>Sub-project (SP) will rehabilitate Tamar Mepe Street and Kvaiti Ubani connecting road with total length of 3 360 m in town Martvili.</p> <p>The SP includes:</p> <ul style="list-style-type: none"> <li>- Rehabilitation of the streets cover with asphalt-concrete layer;</li> <li>- Installation of the concrete ditches ( 1 219 m);</li> <li>- Installation of pipes at the accession of the courtyards;</li> <li>- Arrangement of the retaining wall along the road section pk 5+14 (12 m).</li> </ul>		
Institutional arrangements (WB)	Task Team Leader: Xiaolan Wang	Safeguards Specialist: Darejan Kapanadze	
Implementation arrangements (Borrower)	Implementing entity: Municipal Development Fund of Georgia	Works supervisor: Consulting company Eptisa Servicios de Ingenieria S.L. Spain	Works contractor: Joint venture: Ltd ``Martvilavtogza`` and Ltd ``J and J``
<b>SITE DESCRIPTION</b>			
Name of institution whose premises are to be rehabilitated	Martvili Municipality		
Address and site location of institution whose premises are to be rehabilitated	<p>10, Tavisupleba street, 3100, Martvili            Tel: 0( 418 ) 220060; 577 95 91 93            Email: martvilisgamgeoba@gmail.com</p> <p>The SP site is located in western Georgia, Samegrelo-Zemo Svaneti region. Distance from Tbilisi is 300 km.</p>		
Who owns the land? Who uses the land (formal/informal)?	Municipal property		

<p>Description of physical and natural environment around the site</p>	<p>Town Martvili is administration center of the Martvili municipality. Martvili is located on the edge of the river Akhalitskali. There are 20.1 thousand inhabitants in the town according to the 2002 census.</p> <p>The roads to be rehabilitated are located between private properties (residential houses and yards, orchards, cornfields). Road was constructed decades ago. Nowadays the road is badly damaged that prevents the normal and safe movement of transport; reduce road capacity and leads to an increase in emissions.</p> <p>Due to narrow corridor of road (about 5 m) which lay between private properties (residential yards), arrangement of sidewalks is impossible without involuntary land take. This is advisable neither from financial nor from social standpoint. Speed bumps and limiting signs will be arranged to increase pedestrian safety.</p> <p>Storm water will be discharged into the small streams and in the river Nogela crossed by the road.</p>
<p>Locations and distance for material sourcing, especially aggregates, water, stones?</p>	<p>Water will be available at the construction site from the municipal water supply system.</p> <p>Distance to the nearest licensed borrow pit is approximately 7 km.</p>
<p><b>LEGISLATION</b></p>	
<p>National &amp; local legislation &amp; permits that apply to project activity</p>	<p>The SP has been classified as low risk Category B according to the World Bank policies and the ESMF.</p> <p>Martvili municipal authority approved the SP.</p> <p>Georgian legislation does not require any type of environmental review, approval, or permitting for the SP. Though according to the national regulatory system:</p> <ul style="list-style-type: none"> <li>(i) construction materials must be obtained from licensed providers,</li> <li>(ii) if contractor wishes to open quarries or extract material from river bed (rather than purchasing these materials from other providers), then the contractor must obtain licenses for extraction,</li> <li>(iii) if contractor wishes to operate own asphalt or concrete plant (rather than purchasing these materials from other providers), then the contractor must obtain an environmental permit with an established ceiling of pollutant concentrations in emissions and technical report on inventory of atmospheric air pollution stationary source agreed with Ministry of Environment and Natural Resources Protection.</li> <li>(iv) Permanent placement of the inert material (cut ground and sedimentary soil) generated in the course of earth works in a selected location must be approved by local (municipal) governing bodies in written;</li> </ul>

	<p>(v) Construction waste must be disposed on the nearest municipal landfill in accordance with written mutual agreement with operating company.</p> <p>(vi) Cut of tree branches and disposal of cut vegetation must be approved by local (municipal) governing bodies in written.</p> <p>(vii) Dismantled asbestos pipes must be disposed on the nearest municipal landfill in accordance with Rules and Norms for the Arrangement and Operation of Solid Waste Landfills (December 31, 2013) and based on a written agreement with operating company.</p> <p>GOST and SNIP norms must be adhered.</p>
<b>PUBLIC CONSULTATION</b>	
<p>When / where the public consultation process will take /took place</p>	<p>Draft EMP was disclosed on the web-site of MDF. Hard copies of the document were made available at the MDF and Martvili municipality. Announcement on the public consultation meeting was placed on public information board in the administration building of Martvili municipality Governance.</p> <p>MDF and local municipality organized consultation meeting with local population on July 28, 2015.</p>
<b>ATTACHMENTS</b>	
<p>Attachment 1: Site map and pictures</p> <p>Attachment 2: Record on public consultation</p> <p>Attachment 3: Agreement on waste disposal</p> <p>Attachment 4: Copy Environmental Impact Permit for operating of Asphalt Plant</p> <p>Attachment 5: Copy of License for inert material extraction</p> <p>Attachment 6: Document on disposal of asbestos-containing solid waste</p>	



**PART B: SAFEGUARDS INFORMATION**

<b>ENVIRONMENTAL /SOCIAL SCREENING</b>			
	<b>Activity/Issue</b>	<b>Status</b>	<b>Triggered Actions</b>
Will the site activity include/involve any of the following?	A. Building rehabilitation	<input checked="" type="checkbox"/> Yes <input type="checkbox"/> No	See Section <b>A</b> below
	B. New construction	<input type="checkbox"/> Yes <input checked="" type="checkbox"/> No	See Section <b>A</b> below
	C. Individual wastewater treatment system	<input type="checkbox"/> Yes <input checked="" type="checkbox"/> No	See Section <b>B</b> below
	D. Historic building(s) and districts	<input type="checkbox"/> Yes <input checked="" type="checkbox"/> No	See Section <b>C</b> below
	E. Acquisition of land <sup>1</sup>	<input type="checkbox"/> Yes <input checked="" type="checkbox"/> No	See Section <b>D</b> below
	F. Hazardous or toxic materials <sup>2</sup>	<input checked="" type="checkbox"/> Yes <input type="checkbox"/> No	See Section <b>E</b> below
	G. Impacts on forests and/or protected areas	<input type="checkbox"/> Yes <input checked="" type="checkbox"/> No	See Section <b>F</b> below
	H. Handling / management of medical waste	<input type="checkbox"/> Yes <input checked="" type="checkbox"/> No	See Section <b>G</b> below
	I. Traffic and Pedestrian Safety	<input checked="" type="checkbox"/> Yes <input type="checkbox"/> No	See Section <b>H</b> below

<sup>1</sup> Land acquisitions includes displacement of people, change of livelihood encroachment on private property this is to land that is purchased/transferred and affects people who are living and/or squatters and/or operate a business (kiosks) on land that is being acquired.

<sup>2</sup> Toxic / hazardous material includes but is not limited to asbestos, toxic paints, noxious solvents, removal of lead paint, etc.

**PART C: MITIGATION MEASURES**

ACTIVITY	PARAMETER	MITIGATION MEASURES CHECKLIST
0. General Conditions	Notification and Worker Safety	<ul style="list-style-type: none"> <li>(a) The local construction and environment inspectorates and communities have been notified of upcoming activities</li> <li>(b) The public has been notified of the works through appropriate notification in the media and/or at publicly accessible sites (including the site of the works)</li> <li>(c) All legally required permits have been acquired for construction and/or rehabilitation</li> <li>(d) The Contractor formally agrees that all work will be carried out in a safe and disciplined manner designed to minimize impacts on neighboring residents and environment.</li> <li>(e) Workers' PPE will comply with international good practice (always hardhats, as needed masks and safety glasses, harnesses and safety boots)</li> <li>(f) Appropriate signposting of the sites will inform workers of key rules and regulations to follow.</li> </ul>
A. General Rehabilitation and /or Construction Activities	Air Quality	<ul style="list-style-type: none"> <li>(a) Demolition debris shall be kept in controlled area and sprayed with water mist to reduce debris dust</li> <li>(b) During pneumatic drilling/wall destruction dust shall be suppressed by ongoing water spraying and/or installing dust screen enclosures at site</li> <li>(c) The surrounding environment (sidewalks, roads) shall be kept free of debris to minimize dust</li> <li>(d) There will be no open burning of construction / waste material at the site</li> <li>(e) There will be no excessive idling of construction vehicles at sites</li> <li>(f) Truck loads should be confinement and protected with lining.</li> </ul>
	Noise	<ul style="list-style-type: none"> <li>(a) Construction noise will be limited to restricted times agreed to in the permit</li> <li>(b) During operations the engine covers of generators, air compressors and other powered mechanical equipment shall be closed, and equipment placed as far away from residential areas as possible</li> <li>(c) The machinery should move only along the preliminarily agreed route;</li> <li>(d) The maximum allowed speed should be restricted;</li> <li>(e) Proper technical control and maintenance practices of the machinery should be applied;</li> <li>(f) No-load operations of the vehicles and heavy machinery are not allowed. Proper mufflers will be used on machinery.</li> </ul>
	Water Quality	<ul style="list-style-type: none"> <li>(a) Contractor will be required to organize and cover material storage areas. The material storage sites should be protected from washing out during heavy rain falls and flooding through covering by impermeable materials. Appropriate erosion and sediment control measures will be established such as e.g. hay bales and / or silt fences to prevent sediment from moving off site and causing excessive turbidity in nearby streams and rivers;</li> <li>(b) Contractor will plan all excavations, topsoil and subsoil storage so as to reduce to a minimum any runoff;</li> <li>(c) Revision of vehicles will be required to ensure that there is no leakage of fuel and lubricating materials. All machinery will be maintained and operated such that all leaks and spills of materials will be minimized. Daily plant checks (Vehicle Maintenance Procedure) will be undertaken to ensure no leaks or other problems are apparent. Vehicle maintenance, cleaning, degreasing etc. will be undertaken in designated areas, of hard-standing, not over made ground. Maintenance points will not be located within 50m of any watercourse;</li> </ul>

		<p>(d) Lubricants, fuel and solvents should be stored and used for servicing machinery exclusively in the designated sites, with adequate lining of the ground and confinement of possible operation and emergency spills. Spill containment materials (sorbents, sand, sawing, chips etc.) should be available on construction site;</p> <p>(e) Wet cement and/or concrete will not be allowed to enter any watercourse, pond or ditch.</p>
	Waste management	<p>(a) Waste collection and disposal pathways and sites will be identified for all major waste types expected from demolition and construction activities.</p> <p>(b) Mineral construction and demolition wastes will be separated from general refuse, organic, liquid and chemical wastes by on-site sorting and stored in appropriate containers.</p> <p>(c) Construction waste will be collected and disposed properly by licensed collectors</p> <p>(d) The records of waste disposal will be maintained as proof for proper management as designed.</p> <p>(e) Whenever feasible the contractor will reuse and recycle appropriate and viable materials (except asbestos)</p>
	Material supply	<p>a) Use existing plants, quarries or borrow pits that have appropriate official approval or valid operating license.</p> <p>b) Obtain licenses for any new quarries and/or borrowing areas if their operation is required;</p> <p>c) Reinstate used sections of quarries and/or borrowing areas as extraction proceeds on or properly close quarries if extraction completed and license expired;</p> <p>d) Haul materials in off peak traffic hours;</p> <p>e) Place speed regulating, diverting, and warning signs for traffic as appropriate.</p>
	Protection of trees along the roads	<p>a) Trees along the road must be protected from cutting or unintentional damage;</p> <p>b) Cut of tree branches and disposal of cut vegetation must be approved by local (municipal) governing bodies in written.</p>
<b>E. Toxic Materials</b>	Asbestos management	<p>(a) asbestos located on the SP site shall be marked clearly as hazardous material;</p> <p>(b) asbestos will be appropriately contained and sealed to minimize exposure;</p> <p>(c) The asbestos prior to removal will be treated with a wetting agent to minimize asbestos dust;</p> <p>(d) Asbestos will be handled and disposed by skilled &amp; experienced professionals equipped with special PPE;</p> <p>(e) If asbestos material is stored temporarily, the wastes should be securely enclosed inside closed containments and marked appropriately. Security measures will be taken against unauthorized removal from the site.</p> <p>(f) The removed asbestos will not be reused;</p> <p>(g) The asbestos will finally disposed on the nearest official landfill in accordance with written agreement with landfill operating organization.</p>
<b>H Traffic and Pedestrian Safety</b>	Direct or indirect hazards to public traffic and pedestrians by construction activities	<p>(a) In compliance with national regulations the contractor will insure that the construction site is properly secured and construction related traffic regulated. This includes but is not limited to</p> <ul style="list-style-type: none"> <li>▪ Signposting, warning signs, barriers and traffic diversions: site will be clearly visible and the public warned of all potential hazards</li> <li>▪ Traffic management system and staff training, especially for site access and near-site heavy traffic. Provision of safe passages and crossings for pedestrians where construction traffic interferes.</li> <li>▪ Adjustment of working hours to local traffic patterns, e.g. avoiding major transport activities during rush hours or times of livestock movement</li> </ul>

		<ul style="list-style-type: none"><li>▪ Active traffic management by trained and visible staff at the site, if required for safe and convenient passage for the public.</li><li>▪ Ensuring safe and continuous access to office facilities, shops and residences during renovation activities, if the buildings stay open for the public.</li><li>▪ To arrange speed bumps to reduce vehicle speed and appropriate signs (road narrows/mind pedestrians) in agreement with local traffic police.</li></ul>
--	--	--

**PART D: MONITORING PLAN**

<b>Activity</b>	<b>What</b> (Is the parameter to be monitored?)	<b>Where</b> (Is the parameter to be monitored?)	<b>How</b> (Is the parameter to be monitored?)	<b>When</b> (Define the frequency / or continuous?)	<b>Why</b> (Is the parameter being monitored?)	<b>Who</b> (Is responsible for monitoring?)
<b>CONSTRUCTION PHASE</b>						
Supply with construction materials	Purchase of construction materials from the officially registered suppliers	In the supplier's office or warehouse	Verification of documents	During conclusion of the supply contracts	To ensure technical reliability and safety of infrastructure	MDF, Construction supervisor
Transportation of construction materials and waste  Movement of construction machinery	Technical condition of vehicles and machinery;  Confinement and protection of truck loads with lining;  Respect of the established hours and routes of transportation	Construction site	Inspection	Unannounced inspections during work hours and beyond	Limit pollution of soil and air from emissions;  Limit nuisance to local communities from noise and vibration;  Minimize traffic disruption.	MDF, Construction supervisor, Traffic Police

Sourcing of inert material	<p>Purchase of material from the existing suppliers if feasible;</p> <p>Obtaining of extraction license by the works contract and strict compliance with the license conditions;</p> <p>Terracing of the borrow area, backfilling to the exploited areas of the borrow site, and landscape harmonization;</p> <p>Excavation of river gravel and sand from outside of the water stream, arrangement of protective barriers of gravel between excavation area and the water stream, and no entry of machinery into the water stream.</p>	Borrowing areas	<p>Inspection of documents</p> <p>Inspection of works</p>	In the course of material extraction	<p>Limiting erosion of slopes and degradation of ecosystems and landscapes;</p> <p>Limiting erosion of river banks, water pollution with suspended particles and disruption of aquatic life.</p>	MDF, Construction supervisor
Generation of construction waste	<p>Temporary storage of construction waste in especially allocated areas;</p> <p>Timely disposal of waste to the formally designated locations</p>	<p>Construction site;</p> <p>Waste disposal site</p>	Inspection	Periodically during construction and upon complaints	Prevent pollution of the construction site and nearby area with solid waste	MDF, Construction supervisor
Traffic disruption and limitation of pedestrian access	<p>Installation of traffic limitation/diversion signage;</p> <p>Storage of construction materials and temporary placement of construction waste in a way preventing congestion of access roads</p>	At and around the construction site	Inspection	In the course of construction works	<p>Prevent traffic accidents;</p> <p>Limit nuisance to local residents</p>	MDF, Construction supervisor
Asbestos management	Asbestos located on the SP site is appropriately contained and	Construction site	Inspection of documents	In the course of demolition works	Prevent pollution by toxic materials	MDF, Construction supervisor

	<p>marked clearly as hazardous material;</p> <p>Asbestos is handled and disposed by skilled &amp; experienced professionals equipped with special PPE</p> <p>Security measures are taken against unauthorized removal from the site.</p> <p>The asbestos is disposed in accordance with written agreement with landfill operating organization</p>		Inspection of works		To protect workers' health	
Workers' health and safety	<p>Provision of uniforms and safety gear to workers;</p> <p>Informing of workers and personnel on the personal safety rules and instructions for operating machinery/equipment, and strict compliance with these rules/instructions</p>	Construction site	Inspection	Unannounced inspections in the course of work	Limit occurrence of on-the-job accidents and emergencies	MDF, Construction supervisor
<b>OPERATION PHASE</b>						
Maintenance of rehabilitated road	<p>Maintenance of relevant speed limiting bumps and road signage for traffic safety;</p> <p>Demarcation of the sections of streets under repair;</p> <p>Disposal of asphalt and/or other waste from repair works to the designated landfill.</p>	Rehabilitated sections of roads	Inspection	During maintenance works	Prevent road accidents and disruption of traffic	Martvili municipality

**Attachment 1. Map and pictures of the roads to be rehabilitated**







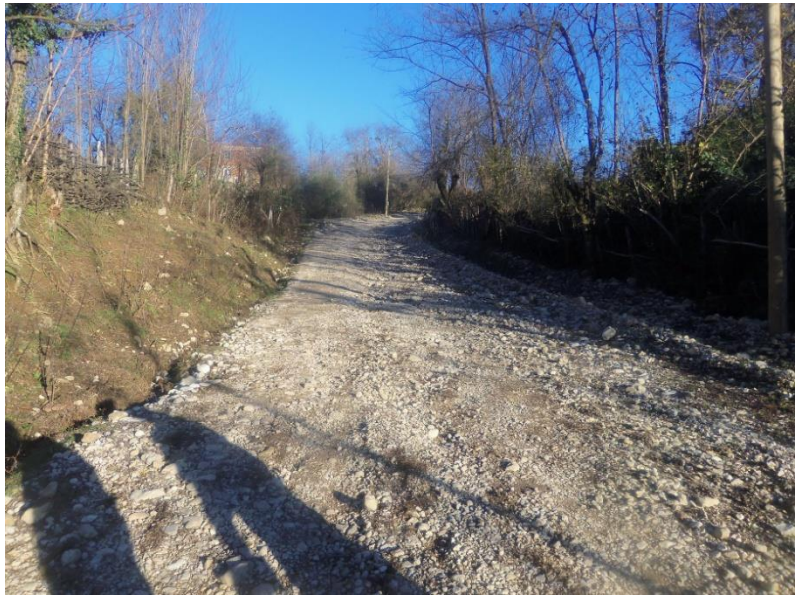

## **Attachment 2: Documents of public consultation**

### **Minutes**

#### **of Public Consultation Meeting**

#### **on Environmental Management Plan for Rehabilitation of Tamar Mepe Street and Kvaiti Neighborhood Connecting Road**

**July 28, 2015**

On July 28, 2015 in the Gamgeoba building of Martvili Municipality, Public Hearings were held on the draft Environmental Management Plan for the SP of Tamar Mepe Street and Kvaiti Neighborhood Connecting Road.

Those present at the meeting:

Representatives of the Martvili Municipality Gamgeoba: Alexandre Grigalava (Gamgebeli), Giorgi Gorozia (Deputy Gamgebeli), representatives of Martvili Kvaiti neighborhood population: Nikoloz Khuntselia, Elguja Khuntselia, Paata Kirtadze, Vazha Gvakharia, Akaki Dzaria, Tea Todua, Nona Khuntselia, Irma Kortkhonjia, Ramaz Diasamidze, Zaal Jikidze, Maia Chochua, Svetlana Kirtadze, Nana Bzhalava, Rolandi Chochua, Valodi Janashia, Taniel Chochua, Nino Khuntselia, Tamar Tsitvia, Giorgi Khuntselia, Koba Khuntselia, Gurami Gelenidze, Vladimer Akhvlediani; Representative of “Martvilavtogza” LTD, Avtandil Tsitskhvaia, Environmental Safety specialists of the Municipal Development Fund of Georgia – Ana Rukhadze and Nino Patarashvili.

The meeting was opened by Alexandre Grigalava, who noted that road rehabilitation is a priority set by the population and lately they have been actively asking for assistance for solving this problem. The project is backed by the World Bank and Municipal Development Fund of Georgia. Certain contribution will be allocated from the local budget.

Ana Rukhadze updated the public on the sub-projects ongoing and planned under Regional and Municipal Development Project II. Afterwards, A. Rukhadze informed the audience of activities planned under the road rehabilitation project and discussed environmental impacts expected as a result the SP activities and measures to be undertaken by the contractor for mitigation or prevention of anticipated adverse impacts of the SP, which are specified in EMP, like inert material disposal only in the officially allocated place, and construction waste disposal at the nearest municipal landfill, as well as noise suppression and air and water pollution preventive measures. A. Rukhadze also noted that under the project, the damaged asbestos drainage pipes will get dismantled and they will be replaced with metal pipes. Asbestos pipes will generate hazardous waste, thus they cannot be handed over to the population. Asbestos pipes shall get

wrapped and disposed at the nearest municipal landfill, according to the existing regulations in force.

At the end of the presentation she informed the participants of the contact persons to be communicated by the population in case of existence of any complaints concerning environmental or social issues.

After the presentation, the audience posed the following questions:

Questions and remarks	Answers and comments
Does the SP envisage asphaltting of lanes?	The SP envisage arrangement of driveways and connections. 5 meter long lane entrances will get asphalted and in the second lane at the beginning of the road – a 200 meter long section will get paved with asphalt.
Does the SP envisage relocation of 4-5 units of power poles existing in the central part of the road, which narrow the road?	The project does not provide for relocation of poles, but certain adjustments may be made to the design, as required.
According to the standard, what is the acceptable width of the road, including the carriageway?	Minimal width of the road is 6 meters, width the carriageway – at least 4,5m. Though, in the villages, where the road is narrowed and adherence to the standard requires involuntary resettlement, which is not advisable neither in financial nor in social terms, the road shoulders are being narrowed. According to the design, carriageway width is 5 meters, graveled shoulders' width – 50-50 cm. A reinforced concrete water diversion canal will be arranged at the certain section of the road (1 219m). Due to narrowness of the road, sidewalks will not be arranged.
At the beginning of the road, one of the inhabitants has recently constructed a shop, which has resulted in road narrowing and risk of traffic accidents, the pedestrians are exposed to hazards, since there is no possibility for two vehicles to maneuver simultaneously in this road section and it will become more dangerous when the asphalt pavement is laid and the traffic accelerates speed. What will happen in this case – will the	Concerning this issue, the Gamgebeli has clarified that it is possible to arrange a 5 meter width road in the indicated section. Consultations will be held with the traffic police and adequate decision will be made with respect to the citizen, whose shop is intruding into the road carriageway.

<p>same width road be subjected to rehabilitation or will it get widened?</p>	
<p>There is no natural gas network in this street. Is it possible that a necessity of road excavation may arise following asphalt laying?</p>	<p>According to the letter of Martvili Municipality Gangeoba to the MDF dated 02.10.14, there are no underground works planned along the design road.</p> <p>The Gangebeli has clarified that an over ground network will be arranged for the natural gas supply.</p>
<p>The population requests for the road rehabilitation works to be performed in high quality.</p>	<p>The local contractor with extensive experience of road rehabilitation projects will carry out rehabilitation works. The works will be supervised by the Project Monitoring Unit of the Municipal Development Fund of Georgia together with the representatives of the international consulting company Eptisa.</p>

Minutes prepared by Ana Rukhadze, MDF Environmental Safety Specialist.  
 July 28, 2015

Annex 1. List of Participants

რეგიონული და მუნიციპალური ინფრასტრუქტურის განვითარების მეორე პროექტი  
 ქალაქ მარტვილის თამარ მეფის ქუჩისა და ქვაითის უბნის დამაკავშირებელი გზის რეაბილიტაცია  
 ქვე-პროექტის გარემოზე ზემოქმედების მართვის გეგმის საჯარო განხილვა  
 28 ივლისი, 2015 წელი  
 შეხვედრაზე დამსწრეთა რეგისტრაციის ფურცელი

	სახელი, გვარი	ორგანიზაცია	საკონტაქტო ინფორმაცია	ხელმოწერა
1.	ნიჟოლოზი ბენძელია			ნ. ბენძელია
2.				<i>[Handwritten signature]</i>
3.	ბენძელია ვიკტორია			<i>[Handwritten signature]</i>
4.	ქიხიაძე ნაიკა			ნ. ქიხიაძე
5.	გვინაძე ვაჟა			ვ. გვინაძე
6.	ბაია ანა		590 57 97 62	ბ. ბაია

7.	6m6 67667am			6m6
8.	am6 ymhahm6m			n. 6m6
9.	6m6m 6m6			6. 6m6
10.	h6m6 6m6m6			h. 6m6
11.	6m6m 6m6m6			6. 6m6
12.	6m6m6 6m6			6. 6m6
13.	6m6m6 6m6m6			6. 6m6m6
14.	6m6m6m6 6m6			6. 6m6
15.	6m6m6 6m6m6			6. 6m6
16.	6m6m6 6m6m6			6. 6m6

17.	Գահազ. Գրքեր			Գ. Գրքեր
18.	Երեսն երկնային			Ե. Երեսն
19.	Երեսն քար			Ե. Երեսն
20.	Երեսն երկնային			Ե. Երեսն
21.	Երեսն երկնային			Ե. Երեսն
22.	Երեսն քար			Ե. Երեսն
23.	Երեսն քար			Ե. Երեսն
24.	Երեսն քար Երեսն քար			Ե. Երեսն
25.				



Annex 2. Photo material of the meeting

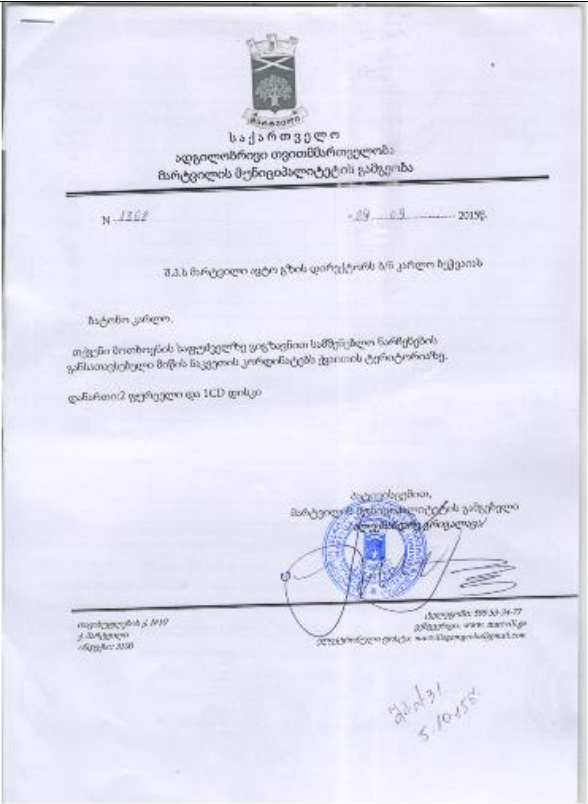

**Attachment 3: Agreement on waste disposal from Martvili municipality**

 <p>The document is a letter from the Martvili Municipality. At the top, it features the coat of arms of Georgia and the text 'ს ა ქ ა რ თ ვ ე ლ ო ადგილობრივი თვითმმართველობა მარტვილის მუნიციპალიტეტის განყოფილება'. Below this, the document number 'N 1222' and the date '29.03.2019' are visible. The recipient is identified as 'შ.პ.ს მარტვილი ფტო გზის დირექტორის პ.ნ კარლო ზეცვაიას ჩატრი კარლო'. The main text states: 'თქვენი მოთხოვნის საფუძველზე ვაწახდით სამუშაო ნაშრომების განსაზღვრული ზონის ნაკვეთს კოორდინატებს ქვემოთ ტერმინოზე, დაჩართი/2 ფერტელი და 1CD ფოსტი'. A blue circular official stamp of the 'მარტვილის მუნიციპალიტეტის განყოფილება' is present, along with a signature. At the bottom left, contact information for 'თელავის ქ. 1019 ქ. მარტვილი რეგისტრაცია' is provided. At the bottom right, there is a phone number 'კვლევისა 999 33 04-77' and an email 'მარტვილი.სსიპ.თავის@ge'. A handwritten note at the bottom center reads 'შ.პ.ს/ 5 10452'.</p>	<p>To the director of LTD “Martviliavtogza”</p> <p>In accordance with your request please find attached the coordinates of the land plot for waste disposal.</p>
---	--

ბრის ნაკვეთის მისამართი		ფართობი	დანიშნულება
მარტვილი, ქვათი		კვ.მ 355	არასპეციალ. - სასაფრეო

წინა ნაკვეთის რეალიზაციის საფეხი	დანიშნულება	მდგომარეობა (მშენებარე ან არა)	სართული	ფართობი	კვ. ფართობი - მ <sup>2</sup>
01					
02					
03					
04					
05					
06					
07					
08					

მოსაზღვრე ნაკვეთის მართლობის მფლობელები (შესაყვანილები)	არსებობს	საკადასტრო აზომვებზე დასტურებული მართვები	საზღლო, ვგარი
1		1	
2		2	
3		3	

დამკვეთი	ძირადი ნომერი
მარტვილის მუნიციპალიტეტის გამგეობა	

საკადასტრო აზომვებზე უფლებამოსილი პირი: *მ. სურშიაძე* / მ. სურშიაძე  
 მისამართი (საკომპიუტერო ინფორმაცია): მარტვილის მუნიციპალიტეტის ქ. #10.  
 ტელ: 593-21-99-34; 598-12-57-52; 598-66-69-63;  
 ელფოსტა: [mamuka125@mts.ge](mailto:mamuka125@mts.ge); ანგარი: mamuka.surshiaძე  
 ჩუგუბურთუბლი: ქ. ფოთის სალუჯო საკადასტრო ინსპექციაში 2007 წლის 18 აგვისტოს.  
 სერია ნომერი # 125404, რეგისტრაციის # 235449537.

საკადასტრო აზომვის ჩატარების თარიღი: 25 აგვისტო 2015 წ.  
 შ.პ.ს. „სურშიაძე“ - 2 0 0 7 7 - 4  
 დირექტორი: *მ. სურშიაძე*  
 დამკვეთი: *მ. სურშიაძე*

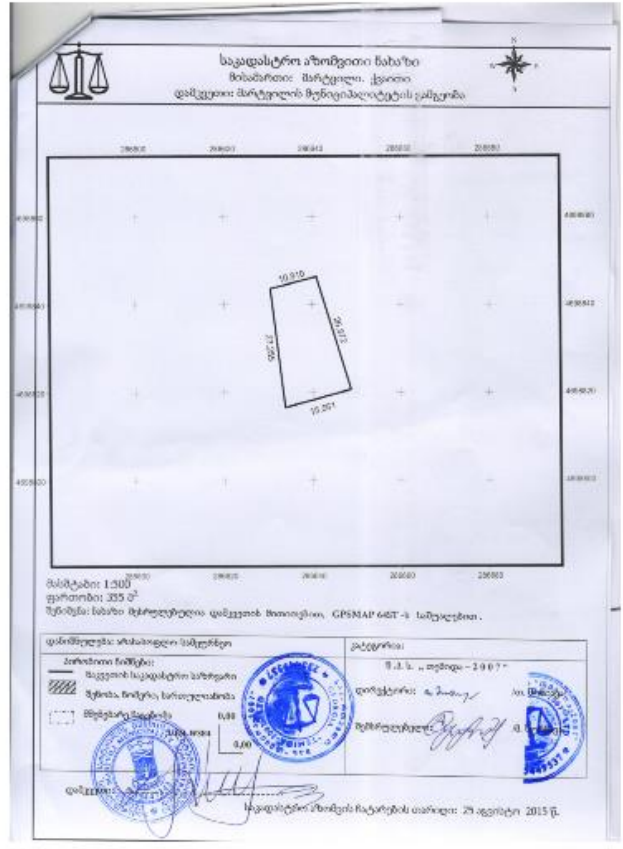

**Attachment 4: Copy Environmental Impact Permit for operating of Asphalt Plant**

  
 საქართველოს გარემოს დაცვისა  
 და ბუნებრივი რესურსების სამინისტრო  
 გარემოზე ზემოქმედების ნებართვა N 000068  
 კოდი MD 1 " 21 " 10 " 2010 წ.

1. ნებართვის მიმღები სუბიექტი შპს „მარტვილიასფალტ“

2. საქმიანობის მიზანი ასფალტის წარმოება

3. განსახორციელებელი საქმიანობის ადგილმდებარეობა ქ. მარტვილი ხოლ. ნაწარგაოს ტერიტორია

4. დოკუმენტაციის მომამზადებელი ორგანიზაცია შპს „გარემოს დაცვის ლაბორატორია“

5. ნებართვის მისაღებად წარმოდგენილი დოკუმენტაცია კარქოზზე ლეიპერის შიდასაფარის აგებაში

6. ნებართვის გაცემის საფუძველი ეკოლოგიური ექსპერტიზის დასკვნა პროექტზე N 67; 28.09.10.

7. ნებართვის პირობები ნებართვა მოქმედებს ეკოლოგიური ექსპერტიზის დასკვნით გათვალისწინებული პირობების შესრულების შემთხვევაში

გარემოზე ზემოქმედების ნებართვა გაცემულია საქართველოს გარემოს დაცვისა და ბუნებრივი რესურსების სამინისტროს მიერ.

საქართველოს გარემოს დაცვისა და ბუნებრივი რესურსების სამინისტროს უფლებამოსილი წარმომადგენელი (გვარი, სახელი, თანამდებობა) ნიკოლოზ ფახნაძე  
 ლეიპერისა და ნებართვის სამსახურის უფროსი

ბ.ა. 

დამკვეთი: საქართველოს გარემოს დაცვისა და ბუნებრივი რესურსების სამინისტრო; დამამზადებელი: შპს „ლაბორატორია“  
 სეს-ს რეგისტრაციის N 10-24

N 000068

**Ministry of Environment Protection and Natural Resources**  
**Environmental impact Permit N000068**

Code: MD1 21.10.2010

1. Permit Holder: LLC “Martvilavtogza”
2. Aim of the Activity: Asphalt production
3. Location: Martvili City, nearby village Nakharebao
4. Author of the document: LLC “Environment Protection Laboratory”
5. Submitted documents to get the permit: Environmental Impact Assessment Report
6. Legal basis of the Permit: Conclusion of Ecological Expertise N67, 28.09.2010
7. Permit conditions: The permit is valid in case all the conditions stated in the conclusion are fulfilled.

Attachment 5: Copy of License for inert material extraction

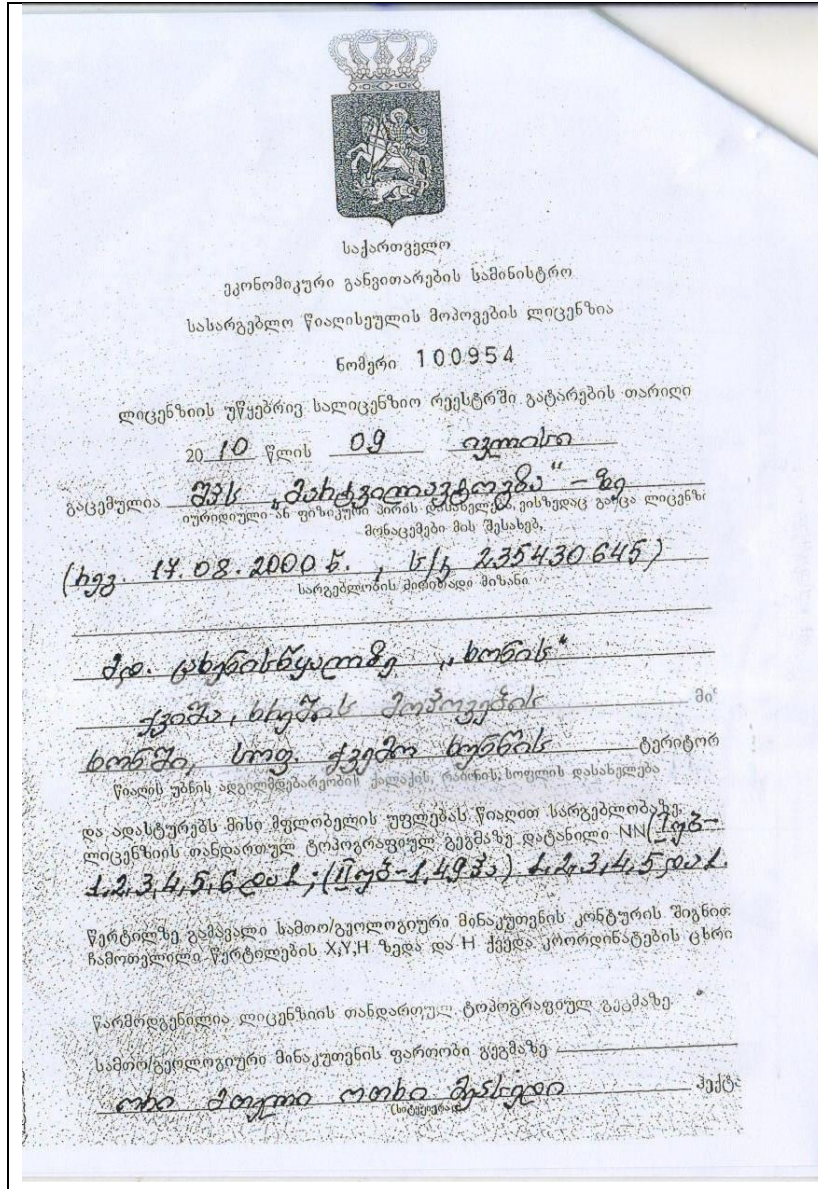

Georgia

Ministry of Economic Development of Georgia

Mineral extraction license

N100954

July 09, 2010

License Holder: LLC "Martvilavtogza"

Legal basis: N1-1/1152 Order of July 09, 2010 of the Minister of Economic Development of Georgia

The licensed area: Khoni, Village Kvemo Khuntsi, Sand and Gravel of River Tskhenistskali

The license is valid for 5 (five) years from July 09, 2010

ეოლოგიური მინაკუთენის მოცულობა \_\_\_\_\_

(სიტყვით)

კუბური მეტრია.

ეოლოგიურ მინაკუთენში მოქცეული

ქვიშა, სიყვი

სასარგებლო წიაღისეულის მარცხენა ნაწილის და სხვა

ობა/მოცულობა \_\_\_\_\_ კუბური მეტრია.

(სიტყვით)

სხელი ქანების მოცულობა \_\_\_\_\_ კუბური მეტრია.

ის კოეფიციენტი \_\_\_\_\_

სარგებლობის ობიექტს საქართველოს ენერჯის და ელექტროენერჯის  
მიწის მინაკუთენის სახელმწიფო საკუთრებაში არსებულ

ჭყვინტიანი ხისხეობის სამინისტროს  
საქართველოს ენერჯის და ელექტროენერჯის მინისტრის განკარგულებაში

— წლის 30.04 N 23-15/1556 თანხმების საფუძველზე

სული მიწის მინაკუთენი საერთო ფართობით 2,04 ჰა.

აიით გათვალისწინებული საქმიანობისთვის განსაზღვრული მიწის

ფენი გამოსახულია ლიცენზიაზე დართულ R-38-49-1-1

ფაქტურის ტოპოგრაფიულ ტოპოგრაფიულ ნაწილზე.

ზღვრულია N 1,2,3,4,5,6 და 1,2,3,4,5 და 1.

რგბზე გამაგალი კონტურით და მისი ფართობი შეადგენს 2,04 ჰა-ს.

ხიბთ გათვალისწინებული საქმიანობის დაწყების ვადა

ლის 09 ივლისი

ხია მოქმედია ხიბია წლის განმავლობაში

სარგებლობის სამუშაოთა წარმოებაში



პარტნიორები არიან \_\_\_\_\_

მოსაკრებელი წიაღით სარგებლობისთვის  
ჭყვინტიანი ხისხეობით სახეობის მინაკუთენის  
მინისტრის განკარგულებაში მარცხენა ნაწილის და სხვა  
ჭყვინტიანი ხისხეობის სამინისტროს

ა) წიაღით სარგებლობის პარამეტრები:

ინიშნული \_\_\_\_\_

მაქსიმალური \_\_\_\_\_

შეუზღუდავი ქვიშა, სიყვის ჯამით მოპოვება - 61,200 მ

ბ) წარმოებული სასაქონლო პროდუქცია \_\_\_\_\_

ა) წარმოებული სასაქონლო პროდუქციის რაოდენობა:

მინიმალური \_\_\_\_\_

მაქსიმალური \_\_\_\_\_

შეუზღუდავი

ჭყვინტიანი ხისხეობის ენერჯის და ელექტროენერჯის  
და მინისტრის განკარგულებაში მარცხენა ნაწილის და სხვა  
ჭყვინტიანი ხისხეობის სამინისტროს

2010 წლის 09 ივლისის N 1-1/152  
ჭყვინტიანი ხისხეობის სამინისტროს



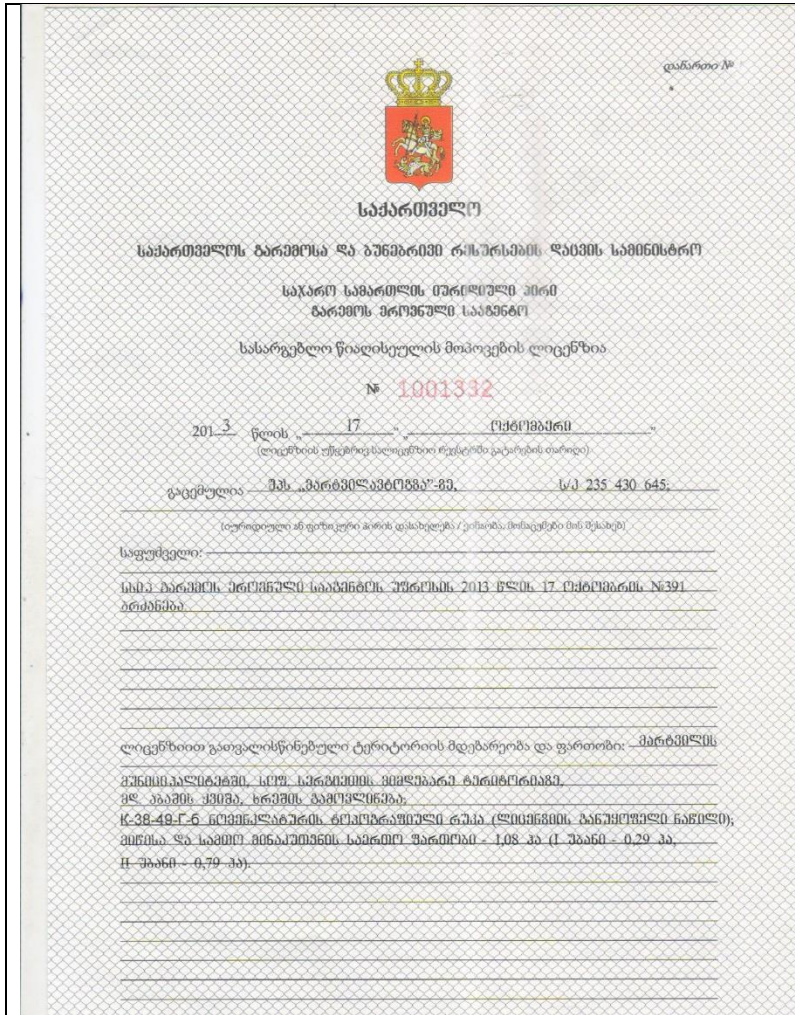

Georgia

Ministry of Environment and  
Natural Resources Protection of Georgia

LEPL National Environmental Agency

Mineral extraction license

N1001332

2013 October 17

License Holder: LLC “Martvilavtogza”

Legal basis: N391 Order of October 17, 2013 of LEPL National Environmental Agency Head

The licensed area: Martvili Municipality, nearby village Sergieti, sand-gravel quarry of river Abasha

The license is valid for three years until from 17.10.2013 until 18.10.2016

მოსაკრებელი რესურსის სახეობა და მოცულობა:

ფიში, ხრამის-ჯამური მუშაობა – 32 400 კუბური მეტრი.

სალიცენზიო პირობები:

ანსაზღვრულია სსიპ „ბაგრატი“ პრექტორი სააპანტო... შრომის 2013 წლის 17 ოქტომბრის  
№391-არქანაქისი.

ლიცენზიის მოქმედების ვადა: — 3 — წელი, — 17.10.2013 დას — 18.10.2016-მდე

სსიპ „ბაგრატის“ ეროვნული სააგენტოს  
უფლებამოსილი წარმომადგენელი

  
(სტამბა)



დამკვეთი: სსიპ ბაგრატის ეროვნული სააგენტო  
დასრულებულია: მს. კონტაქტ  
სტრ-პროექტების №23-4000

გავედრე ლიცენზიის პირობებს და  
ვიღებ ვასუბსიდენტობის მათ  
მესრულებაზე.

  
ჩელმწევა





Attachment 6: Document on disposal of asbestos-containing solid waste

**პოლიგონზე მყარი ნარჩენების განთავსების აქტი** **00636**

თარიღი: 12.12.2015წ



**შპს სახარბაშოსი მყარი ნარჩენების მართვის კომპანია**  
LTD SOLID WASTE MANAGEMENT COMPANY OF GEORGIA

შპს "საქართველოს მყარი ნარჩენების მართვის კომპანია"

ნაგებობის მდებარეობა:	<u>სახარბაშო</u>
მიმღების სახელი:	<u>საქონი</u>
მიმღების ვაჭარი:	<u>საქონი</u>
მიმღების თანამდებ:	<u>შპს "საქართველოს მყარი ნარჩენების მართვის კომპანია"</u>

ფიზიკური / იურიდიული პირის დასახელება:	<u>შპს სახარბაშო</u>
პირადი ნომერი / საიდენტიფიკაციო კოდი:	<u>235430845</u>
საკონტაქტო ინფორმაცია:	<u>ს. სახარბაშო, თბილისი 118 599 30-35-98</u>
იურიდიული პირის წარმომადგენელი:	<u>შალომე წყნაძე</u>
ავტომობილის ნომერი:	<u>365917</u>
ავტომობილის მფლობელი:	<u>ივანე წიმიანი</u>
მისამართი:	<u>საქართველოს მყარი ნარჩენების მართვის კომპანია</u>

#	ნარჩენის ტიპი	რ-ბა [ტონა]	ერთეულის ფასი [დღგ-ს ჩათვლით]	ჯამი [დღგ-ს ჩათვლით]
1	<u>საქონი/მყარი ნარჩენი (ასბესტის შექცევის ნარჩენი)</u>	<u>3,55</u>	<u>35</u>	<u>124,25</u>
2	<u>"</u>	<u>1,775</u>	<u>35</u>	<u>62,125</u>
3				
		<u>სულ</u>		<u>186,375</u>

ლარი

საბოლოო ღირებულება: 186,375 ლარი

თანხა სიტყვიერად: ასობისმოსწამწამის მათი ზე 0,375 თეთრი

შენიშვნა:

დამატებითი ინფორმაცია:  
 აღნიშნული თანხა ჩარიცხული უნდა იქნეს ქვებით მითითებულ საბანკო ანგარიშზე. აქტის გამოწერილიდან არსებულიდან 10 (ათი) კალენდარული დღის განმავლობაში. წინააღმდეგ შემთხვევაში გააჩნდება საქართველოს კანონმდებლობით გათვალისწინებული საჯაროობის სანქციები.

მიმღების ხელმოწერა

შემამტანი ფაქს / იურიდიული პირის ხელმოწერა

საკონტაქტო ინფორმაცია  
 ს/კ: 404942470  
 პოლიტექსკავიას ქ. 10, თბილისი, 0186;  
 ტელ: (+995) 32 / 243 88 30  
 www.waste.gov.ge info@waste.gov.ge

საბანკო რეკვიზიტები  
 მომსახურებელი ბანკი:  
 ბანკის კოდი:  
 ანგარიშის ნომერი:  
 მიმღები:

სს "თიბისი ბანკი"  
 TBCBGE22  
 GE 51TB 7161 9360 8010 0005  
 შპს "საქართველოს მყარი ნარჩენების მართვის კომპანია"